

I □ in-out system



70 □ in-out FLY



L □ in-out DRIVE

Sistem IN-OUT ALU-system

» Solutii sisteme culisare usi «

I. Prezentare:

Usile culisante alu-system pot fi in sistem incadrat tip:

- “drive”, aplicata partea superioara
- “fly”, incadrata inferior
- “angle”, incadrata unghiular pentru zonele de intersectie acoperis (tavan) cu perete lateral

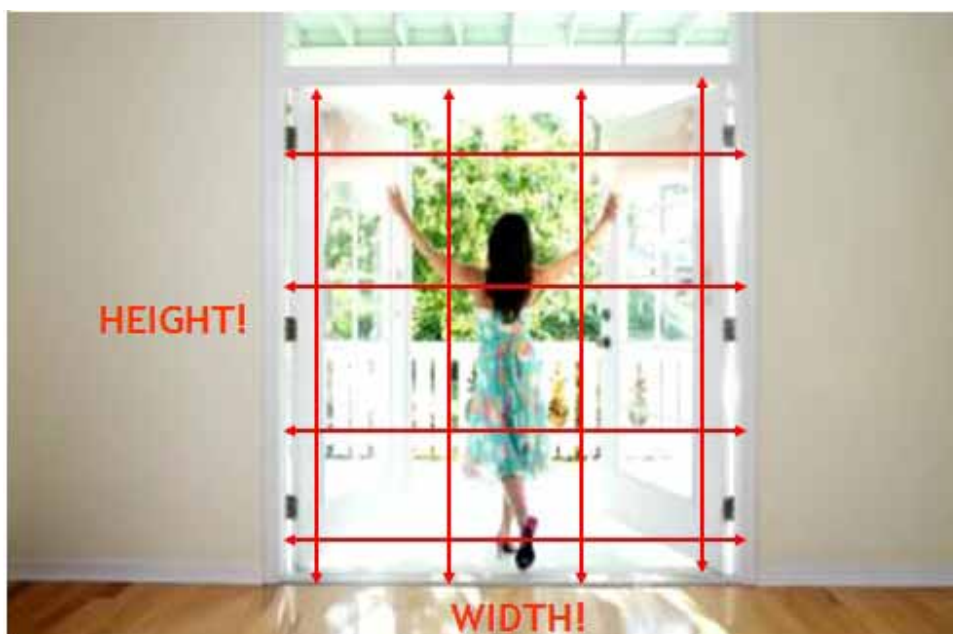

RECOMANDARI DE UTILIZARE:

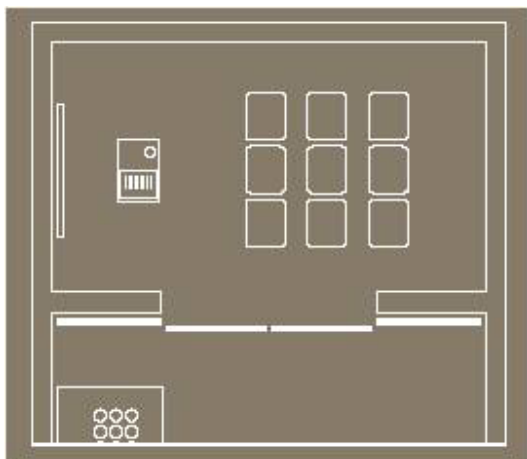

SISTEM DE SEPARARE

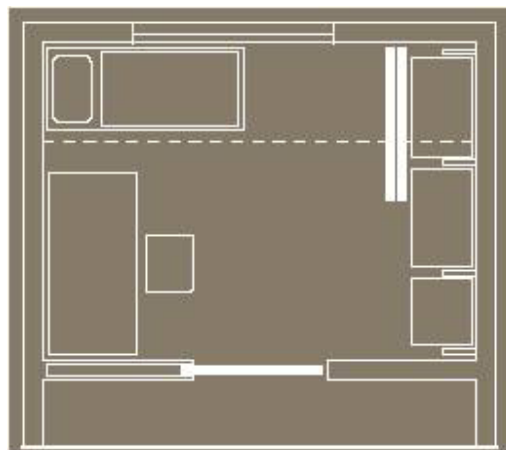

**USA CARE INTRA IN PERETE SI
USA PENTRU GARDEROBA**

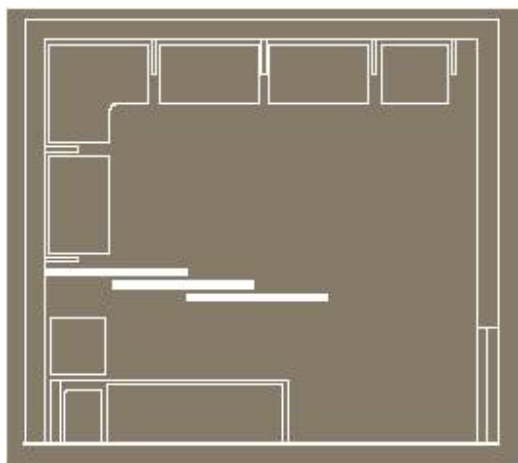

USA PENTRU DRESSING

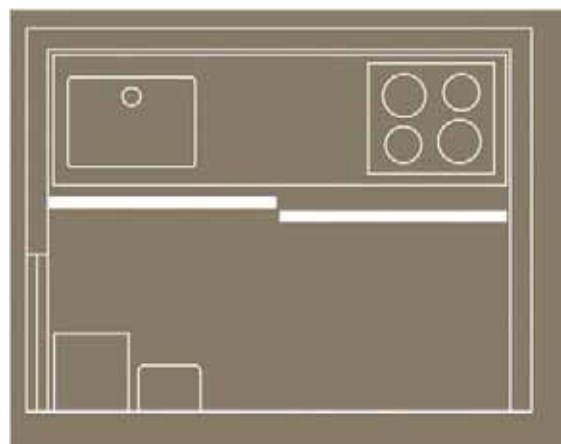

USA SEPARARE BUCATARIE

| □ in-out system

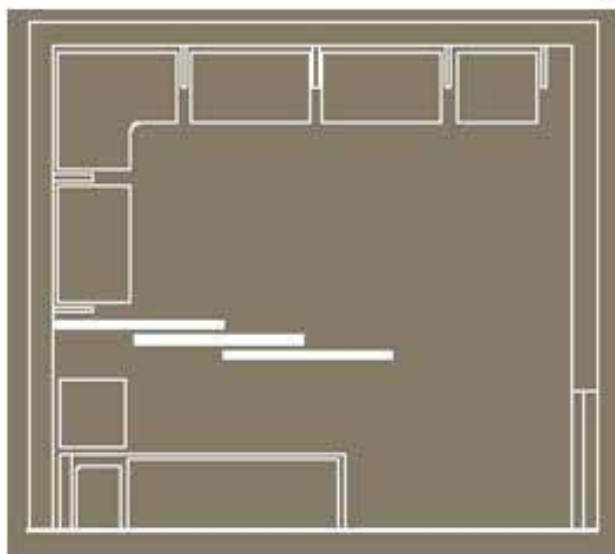

| AJTÓS | 1-TÜRIG | 1 DOOR

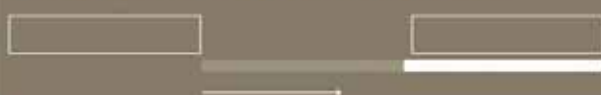

1 door with 1 rail running in front of the wall
(can slide to the left and/or to the right)



1 door with 1 rail that can slide into the wall
(can slide to the left and/or to the right)

2 AJTÓS | 2-TÜRIG | 2 DOORS



2 doors with 1 rail running in front of the wall



2 doors with 1 rail that can slide into the wall



2 doors with 2 rails running between the walls
(can slide to the left and/or to the right)

3 AJTÓS | 3-TÜRIG | 3 DOORS



3 doors with 2 rails running
in front of the wall
(can slide to the left and/or to the right)



3 doors with 2 rails running
between the walls
(can slide to the left and/or to the right)



3 doors with 3 rail, running
between the walls
(can slide to the left and/or to the right)

4 AJTÓS | 4-TÜRIG | 4 DOORS



4 doors with 2 rails running
in front of the wall
(can slide to the left and/or to the right)



4 doors with 2 rails running
between the walls
(can slide to the left and/or to the right)

II. Solutii tehnice:

Sistemul este durabil, din aluminiu, silentios, cu un rulaj aproape perfect.

DIMENSIUNEA MAXIMA A USII

ARTICOLUL NR.	DM	INALTIME mm x LATIME mm
SAS 510.200.00	22 x 35	2700 x 1200
SAS 510.202.00	40 x 35	3000 x 1500

SAS 510.200.00
(22 mm x 35 mm)



SAS 510.202.0
(40 mm x 35 mm)

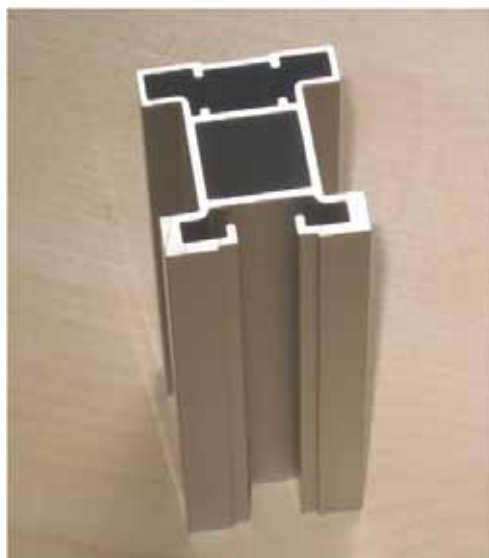

| □ in-out system

Profile

L □ in-out DRIVE

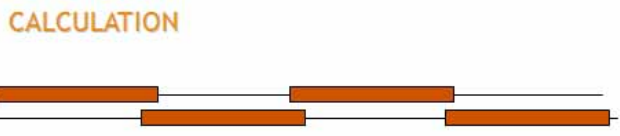
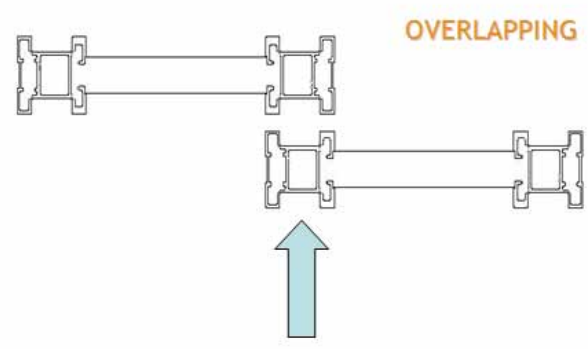
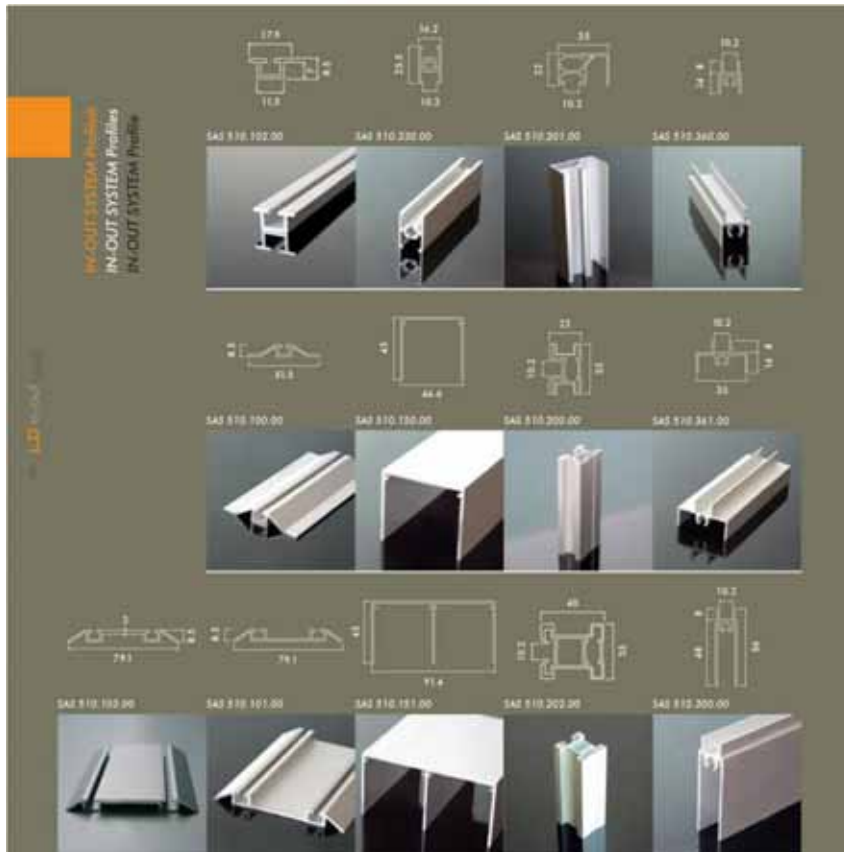

70 in-out FLY



IN-OUT FLY Profilok
IN-OUT FLY Profiles
IN-OUT FLY Profile

IN-OUT FLY Vasakal
IN-OUT SYSTEM Fittings
IN-OUT SYSTEM Beschläge

SAS 630.110
SAS 630.120



IN-OUT FLY Egyéb kiegészítők
IN-OUT SYSTEM Additional items
IN-OUT SYSTEM Zubehöre

SAS 630.010.11

SAS 650.000.11





















SAS 650.020.11

SAS 440.110.00

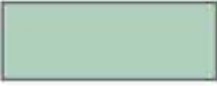
Materialele pot fi simple, cu 2 sau 3 ochiuri. In interiorul ochiurilor se pot pune diferite materiale, cum ar fi PAL, PFL, MDF cu folie, sticla sau chiar stofa!

4 MM

INLAYS

				
	RED	BEIGE	BLUE	GREEN
GLASS				
	BORDEAUX	ORANGE	BLACK	WHITE
		(WITH SAFETY FOIL ON THE BACK)		
	MIRROR			
ACRYL GLAS				
	TRANSP.	FA?	RED	DARK BLUEU
				
	GREEN	ORANGE	GRAY	PINK
				
LIGHT BLUE	JELLOW			

6 MM

INLAYS

GLASS



LAMINATED
CLEAR

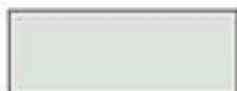

LAMINATED
MATT



LAMINATED
CLEAR - BROWN
BAROQUE
DEKOR



LAMINATED MATT-
BROWN BAROQUE
DEKOR



LAMINATED
CLEAR - BLACK
BAROQUE
DEKOR



LAMINATED
MATT - BLACK
BAROQUE DEKOR



LAMINATED
CLEAR - WHITE
BAROQUE
DEKOR



LAMINATED
MATT - WHITE
BAROQUE
DEKOR



|  in-out system

6 / 10 MM

LEATHER

INLAYS

ONE-SIDED 10 MM



TWO-SIDED 6 MM

10 MM

INLAYS

VENEERED



HASELNUT



WENGE



ZEBRANO

LAMINATED



WENGE



WALNUT



BEECHE



CHERRY



IVORY



ORANGE
GESTREIFT /
GLATT



WEISS

|  in-out system

10 MM

INLAYS

LAQUERED MDF



SOUR CHERRY



WEISS



BEIGE



BLUE



GRAY



BLACK



IVORY



ORANGE

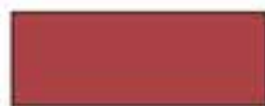

BORDEAUX

PRETUL SISTEMELOR

Pretul difera in functie de dimensiunea golului, inaltimea si latimea usii, numarul de ochiuri din usa, profilul ales – latimea lui, sina aleasa (numarul de canale). Astfel, cu cat este mai simpla cu atat este mai ieftina.

Pretul se calculeaza automat cu ajutorul programelor speciale instalate pe computerele agentilor nostri sau pe cele de la fabrica.

The screenshot shows the 'InOut Fly System 1.5.7' software interface. It is divided into two tabs: 'Giving Basic Information I.' and 'Giving Basic Information II.'. The 'Giving Basic Information I.' tab is active and contains the following fields and options:

- Quotation Nr.: [] Date: 2007.09.26
- Customer: Alina Mures
- Adresse1: []
- Adresse2: []
- Packing mode: Standard
- Installation options:
 - walk-to-wall building - fixing to the ceiling
 - covering door-holes - fixing to the wall
- Wall or ceiling material: [] (Dropdown menu with options: Timber, Concrete, Brick, Plasterboard, Other)
- Height of the Room: 2 700 mm
- Width of the Room: 2 500 mm
- Profiles finishes: AL1 Natural Matt Anodized
- Vertical profile:
 - 510.202.00 wide
 - 510.203.00 round
- Number of Doors (between 1-6): 2 pc(s) Height of the Door: 2 635 mm
- Width of the Door:
 - Door 1: 1 270 mm
 - Door 2: 1 270 mm
- Profile for Rollers (610.150.00): 2 pc(s) Cover profile (610.100.00): 2 pc(s)
- Lower connection support set (630.010.11):
 - Yes
 - No
- Side-closing element (640.110.00):
 - Yes
 - No
- Back sealing brush (520.200.11):
 - Yes
 - No
- Allen key (550.200):
 - Yes
 - No

Buttons: New Quotation, >>Next, Read, Exit. A small image of a door system is visible on the right side of the window.

Exemplu de calculare (estimare)

Pentru gol h=2450x2400	2 usi – 3 ochiuri	548 €
	3 usi – 3 ochiuri	705 €
	2 usi simple	470 €
	3 usi simple	641 €

Optional se pot pune perie antipraf si amortizoare, dar acestea se fac cu costuri suplimentare.

I □ in-out system

L □ in-out DRIVE



|  in-out system



|  in-out system

Mobilier
NORVINIA
www.norvinia.ro



|  in-out system



|  in-out system



I □ in-out system



70 in-out FLY



| □ in-out system

Mobilier
NORVINIA
www.norvinia.ro



|  in-out system



| □ in-out system



□ in-out DRIVE ANGELED DOORS

